

Installation Guides

DOUBLE ROD WITH FRENCH RETURNS

SHADE  LOVE

Installing Shade Love Drapery & Hardware



Thanks for choosing Shade Love Drapery & Hardware. Prior to installation, we recommend that you thoroughly review this manual.

Should you need further assistance, please feel free to contact us at info@shade-love.com.

Gather your tools

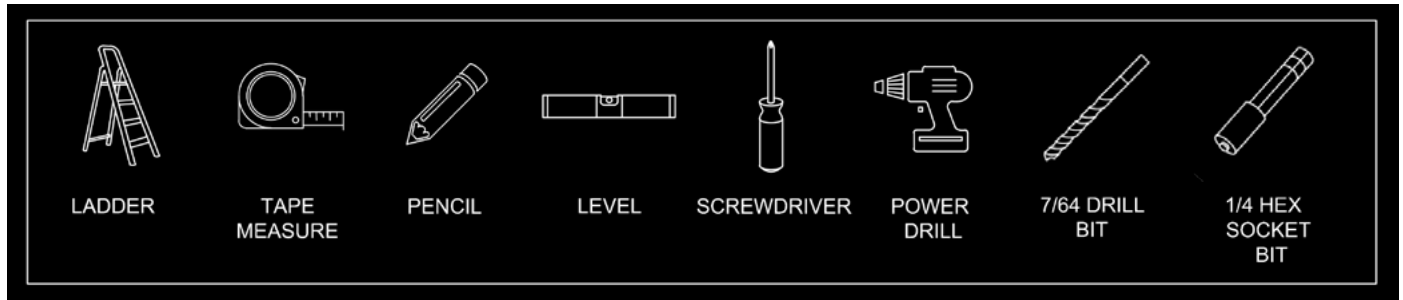

Preparation

First, organize your hardware by window and confirm that all parts are present. Then, proceed to installation. We recommend that you read all the guidelines below before beginning installation.

A NOTE ON THE MOUNTING HARDWARE

The screw holes in our brackets are $\frac{1}{4}$ " in diameter. Your wood screws are #8 x 2" and provide some wiggle room to make minor level adjustments to the brackets. Wood screws should only be used for mounting brackets directly into solid wood such as a stud or header. The Snap Toggles, along with the $\frac{3}{16}$ "-24 machine screws provided should be used if mounting into hollow drywall or plaster. See Appendix for additional Snap Toggle installation instructions. It is very important to use mounting hardware that is appropriate for your mounting surface.

Installation

STEP 1 Assemble rod

If the rod is spliced in half, assemble the rod using the internal splice connector.

- A. Loosen set screws on rod ends using the Allen key provided (3/32").
- B. Insert splice connector (8" to 10" long piece of tubing that is ¼" smaller in diameter than the rod) halfway into each rod end. [Fig. 1]
- C. Re-tighten set screws.
- D. The set screws may need to be adjusted to make sure the tops of the rod segments are flush.

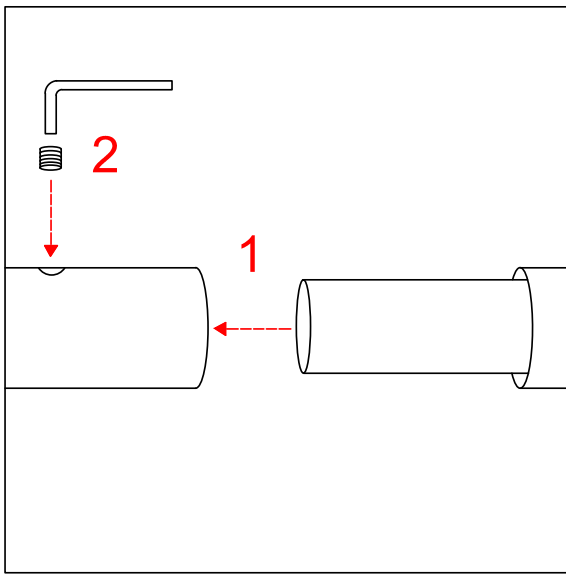

Fig. 1

STEP 2 Screw return legs

Loosen set screws on bottom of return legs and insert posts, then retighten set screws (set screws on return legs should be facing downward when installed).

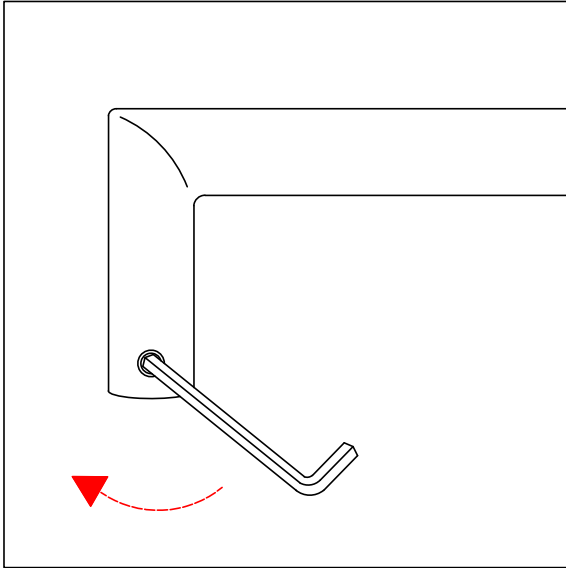

Fig. 2

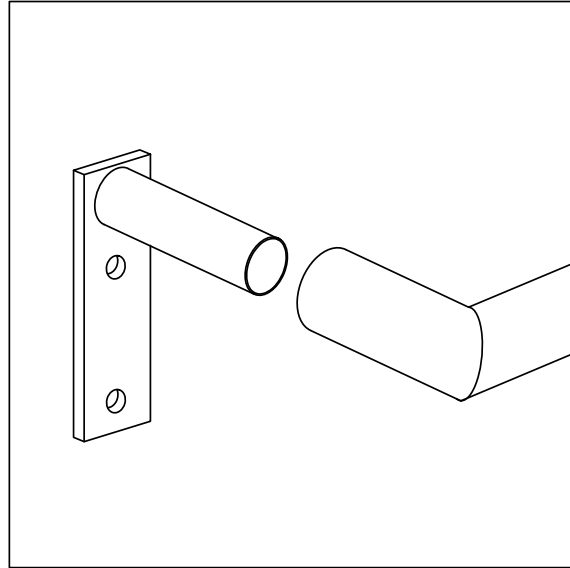

Fig. 3

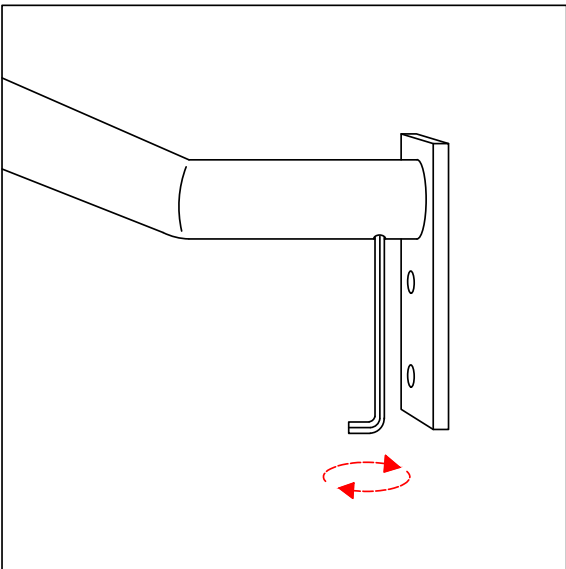

Fig. 4

STEP 3 Locate post brackets mounting position

- A. Start by moving away from the left outer edge of your window, then find where the left stack width and mounting height intersect.
- B. Hold up the rod to the wall and mark positions of post brackets with pencil (the backplate should be vertical).

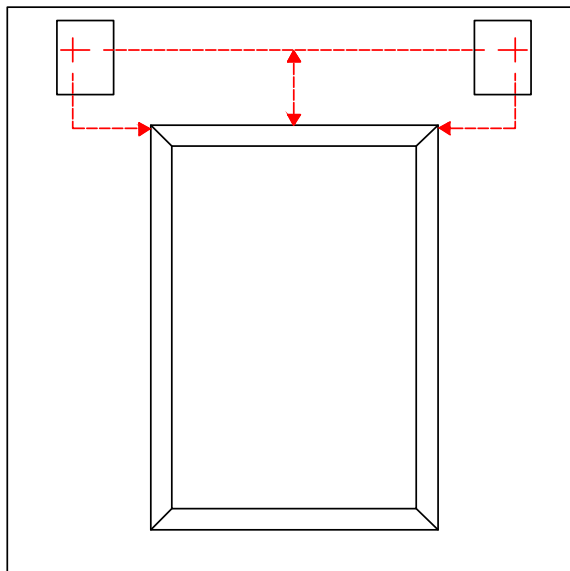

Fig. 5

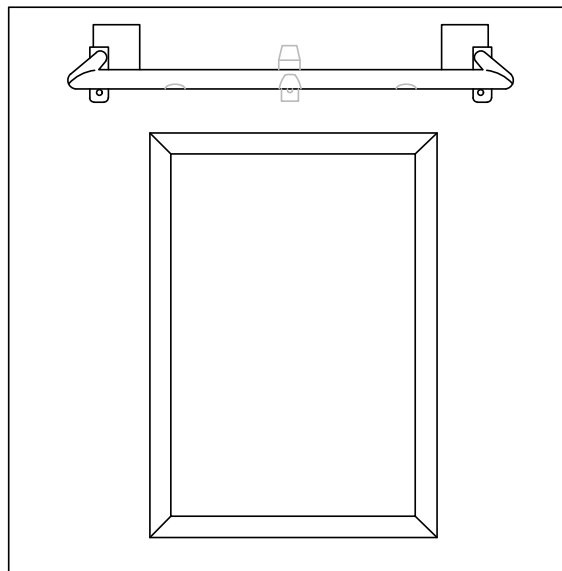

Fig. 6

STEP 4 Install post brackets

Remove rod ends from post brackets, and after verifying positioning with a level, install post brackets.

- A. Use wood screws for mounting into a stud or header.
- B. Use Snap Toggles and machine screws for mounting into hollow drywall or plaster (see additional Snap Toggle directions in Appendix).

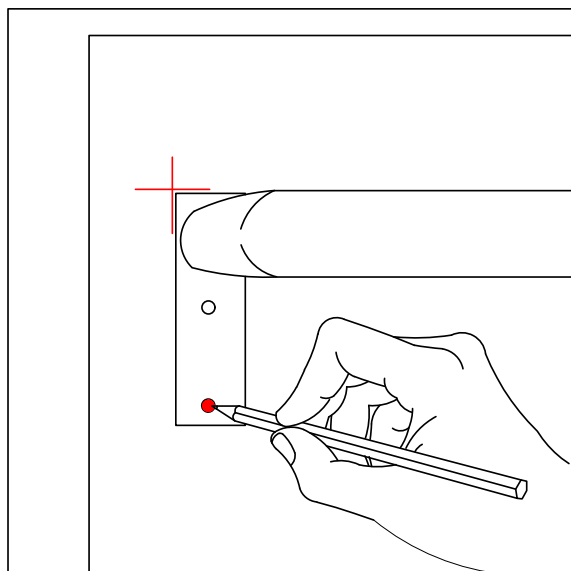

Fig. 7

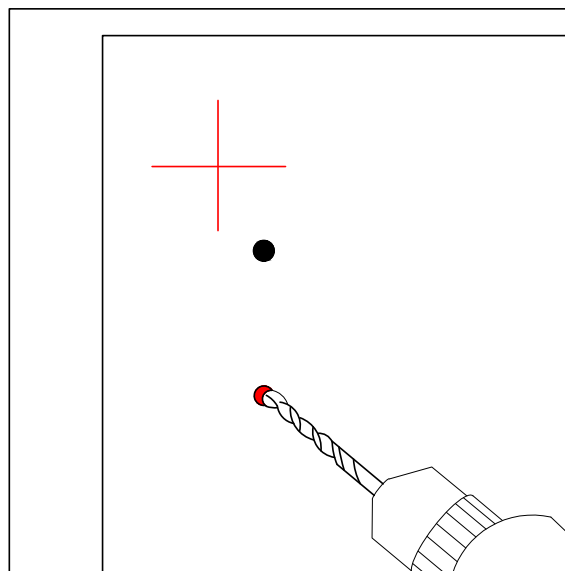

Fig. 8

STEP 5 Install the back rod using the socket brackets

- A. The socket bracket backplates are pre-installed on the inside walls of the return legs.
- B. Loosen both set screws on socket sleeve using the Allen key provided (3/32").
- C. Slide the socket sleeve over the rod, hold the rod end up to the backplate, slide the sleeve back over the backplate, and retighten both set screws.

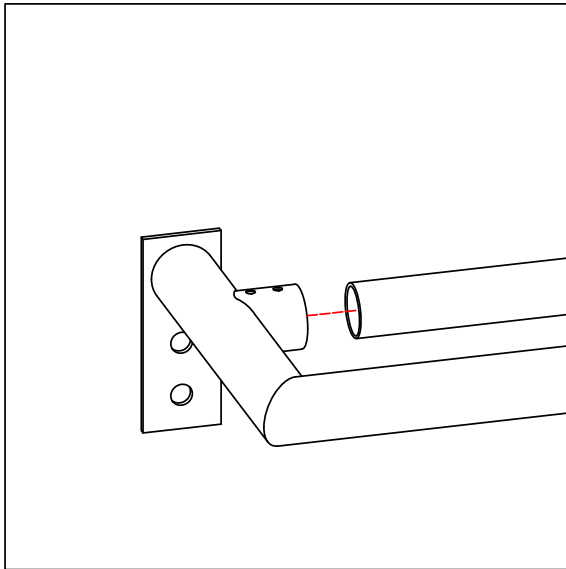

Fig. 9

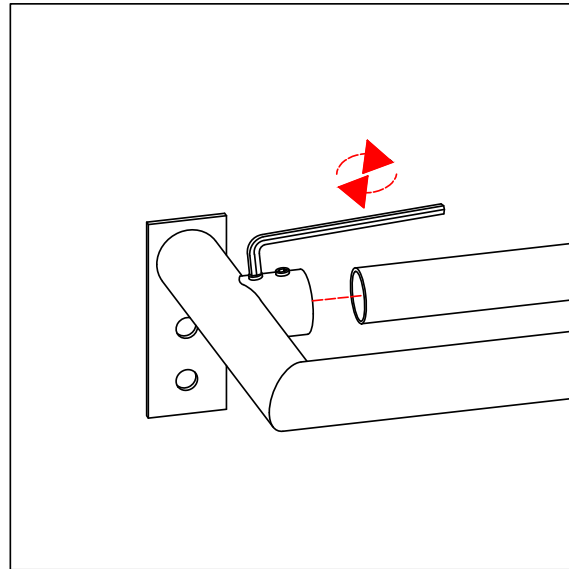

Fig. 10

STEP 6 Install a central bracket (Does not apply for all products)

If the rod is spliced, a bracket should support each splice point. Hold up center bracket to determine mounting position and mark with a pencil. Installation of center bracket can be done with or without the rod resting in the end brackets.

- A. Use wood screws for mounting into a stud or header.
- B. Use Snap Toggles and machine screws for mounting into hollow drywall or plaster (see additional Snap Toggle directions in Appendix).

STEP 7 Assemble rings on curtain rod

Place the same number of rings on the rod as there are hooks on your drapery panels. If you have a single, unspliced rod, start assembling your rings. If you've added a center bracket, distribute the rings evenly between each side before proceeding.

STEP 8 Hang sheers and drapes

First hang sheers, and then drapes. Starting from the farthest left ring, thread the farthest left hook of your drapery panel through the ring's eyelet until the panel is fully secured. Repeat if there are any additional panels.

Appendix

Snap Toggle Instructions

1. Drill 1/2" hole. Hold metal channel flat alongside plastic straps and slide channel through hole. Minimum clearance behind wall: 1 7/8".

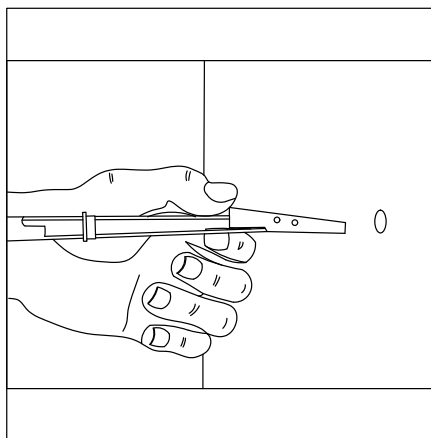

2. Hold ends of straps between thumb and forefinger and pull toward you until channel rests flush behind wall. Slide plastic cap along straps with other hand until flange of cap is flush with wall.

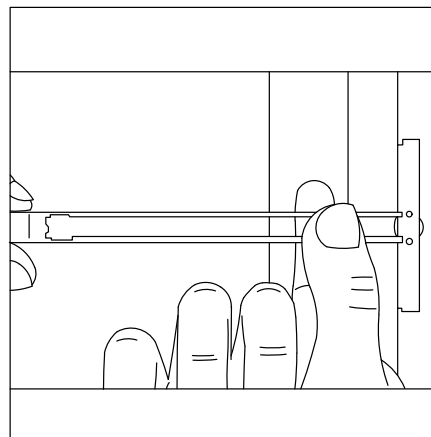

3. Snap straps at wall by pushing side to side, snapping off straps level with flange of cap.

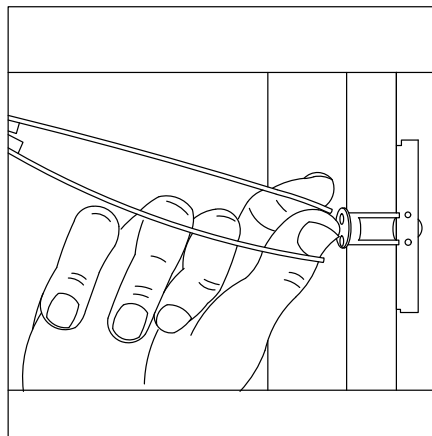

4. Place bracket over flange. Insert machine screw and tighten until snug against bracket, then stop.

